



#### Technical features:

- steel towel warmer radiator
- horizontal elements featuring rectangular tubes 20x25 mm section
- side round manifolds with a 30 mm diameter
- manifold threading 1/2" Gas right
- maximum working pressure 4 bar
- maximum working temperature 95°C
- radiator hydraulic equipped with a booster mounted behind the radiator with a power of 1,000 watts

#### Price included:

- 4 wall fixing in the same color as the radiator
- 1/2" air vent

Finishes available	Surcharge
Standard White	
Classic finished	
Special finished	
Other RAL colors	

Finishing codes see page 596.



#### Connections

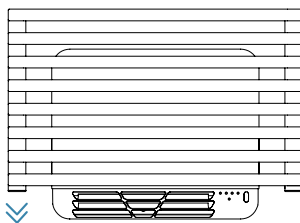

Laterals

#### Connection dimensions with IRSAP valves

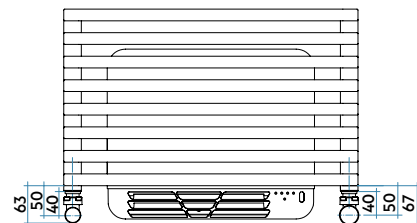

#### Booster



#### MAIN CHARACTERISTICS OF AIR DIFFUSER

- ON/OFF switch
- Power supply 230 V 50 Hz, 1 ph
- Power installed = 1000 W
- Insulation: CLASSE II
- Connecting to a network equipment that comes with the phase and neutral version without plug or with Schuko plug
- Protection index: IP24
- Long electricity cable: 1.200 mm
- Electronic ambient thermostat

# NET AIR MIX

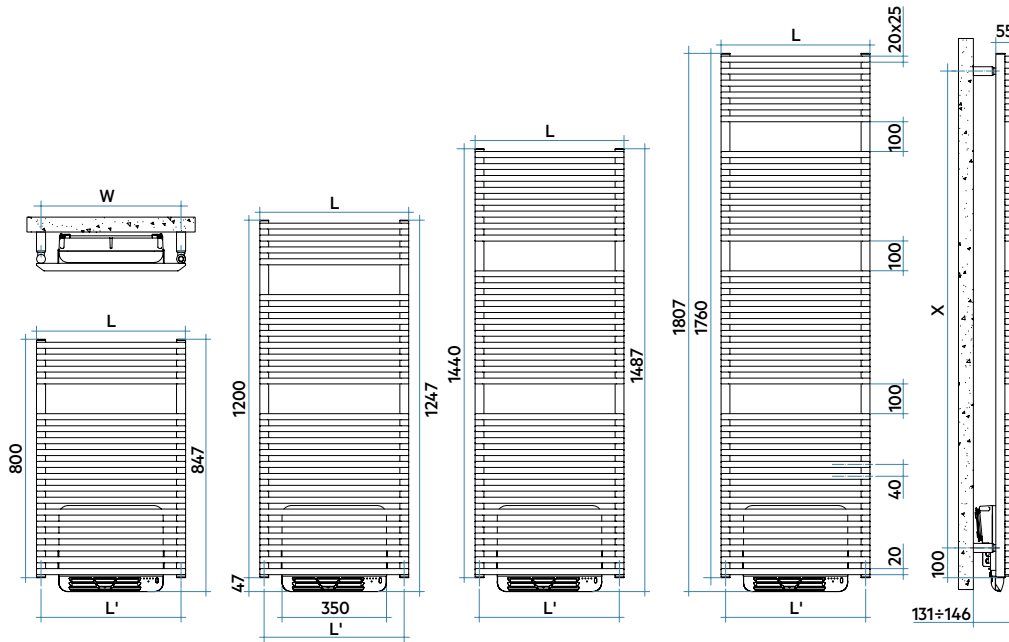

Model	Code	Depth P mm	Height H mm	Width L mm	Conn. C. L' mm	Weight Kg	Cap. lt	Thermal Power				Auxiliary heater		
								$\Delta t=50^{\circ}\text{C}$ Watt	$\Delta t=40^{\circ}\text{C}$ Watt	$\Delta t=30^{\circ}\text{C}$ Watt (*)	$\Delta t=20^{\circ}\text{C}$ Watt	Exp. n.	with diffuser Watt	
800 18 rails 1 espace	<b>NRS050 B 01 IR 01 NNN</b>	124	847	500	470	10,2	4,6	1525	<b>447</b>	340	<b>239</b>	145	1,230	+ 1000
1200 26 rails 2 espaces	<b>NRM050 B 01 IR 01 NNN</b>	124	1247	500	470	13,7	6,7	2252	<b>660</b>	504	<b>355</b>	218	1,211	+ 1000
1440 32 rails 2 espaces	<b>NRL050 B 01 IR 01 NNN</b>	124	1487	500	470	16,2	8,2	2672	<b>783</b>	597	<b>421</b>	257	1,216	+ 1000
1760 38 rails 3 espaces	<b>NRE050 B 01 IR 01 NNN</b>	124	1807	500	470	18,8	9,8	3214	<b>942</b>	718	<b>507</b>	310	1,214	+ 1000

BATHROOMS  
RADIATORS

(\*) Thanks to the high performance of Irsap NET AIR MIX radiators, the ideal  $\Delta t$  for low temperature projects is  $\Delta t$  at  $30^{\circ}\text{C}$ .  
For  $\Delta t$  different from  $50^{\circ}\text{C}$  use the formula:  $Q=Q_n (\Delta t / 50)^n$

### Key Codes

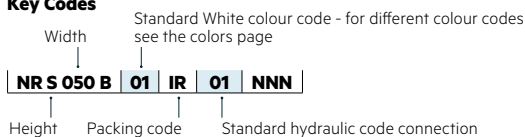

### Wireless Remote Control (optional) for booster control

NET Air Mix is equipped with a controller that allows remote management of every electric radiator function. Because the controller is wireless, it has the advantage of being quick and easy to install and does not require any modifications within the home.

#### REELETRAS2501N

#### Technical specifications

- Wireless communication via radio signals transmitted to the receiver connected to the system.
- Approx. 30-50 metre range in residential environments (868 MHz).
- Radiofrequency communication pursuant to European standards.
- You can activate the manual functions



### Decorative & Technical Accessories

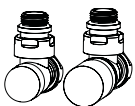

Kit Valves and  
Lockshield valve  
Pag. 562

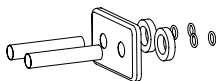

Pipe cover kit  
Pag. 566